

# LEVEL-RIGHT<sup>®</sup> PRO

MASTER GRADE<sup>®</sup> PRECISION RETICLE LEVEL



## INSTRUCTION GUIDE

### LEVEL-RIGHT PRO QUICK START INSTRUCTIONS

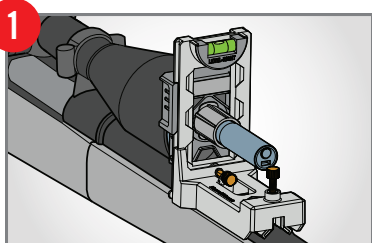

1 Place assembled Level-Right Pro on gun barrel and scope (which should already be in Leveling Vise). Level gun and scope using integrated bubble level.

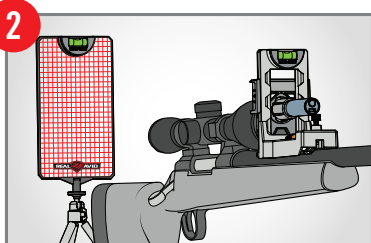

2 Assemble and place Precision Alignment Grid behind gun. Adjust the grid so it is level.

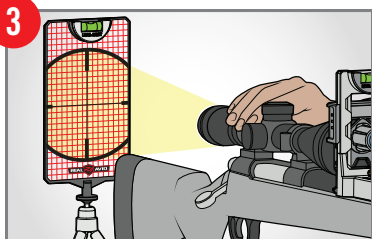

3 Turn on Light Projector and adjust scope magnification to get a crisp reticle projection on the Precision Alignment Grid.

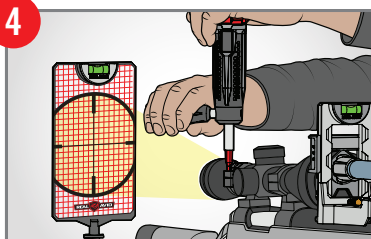

4 Twist Scope until reticle projection is perfectly aligned with the grid lines on the Precision Alignment Grid. Tighten scope rings to manufacturer's recommendations.



# LEVEL-RIGHT® PRO

## MASTER GRADE® PRECISION RETICLE LEVEL

### BEFORE YOU GET STARTED

If you've leveled a scope before, you know the process can be cumbersome and frustrating. Keeping multiple bubble levels aligned on the gun and scope is difficult and time consuming. Level-Right Pro changes that by eliminating extra leveling requirements and getting your gun and scope reticle level in the same easy step. Here's what you should do before you get started:

1. Unload gun and then place it on leveling vise and lock down (no need to level at this point) Attach your scope base and lower scope rings to the gun according to the manufacturer's recommendation.
2. Place scope onto lower scope rings, then very loosely install upper scope rings so scope is held to gun. Scope should be able to easily move forward and rearward as well as twist within the rings.
3. Set your eye relief. This pertains to the distance from the scope eye piece to your eye when holding the rifle. It is best to take the rifle and scope out of the vise and hold it as if you were going to shoot (Always point in a safe direction). This is simply to identify the required position (forward or rearward) the scope needs to be in order for an unobstructed clear view of the entire reticle. Do not worry about leveling the reticle at this time.
4. Once eye relief position is set, place gun and scope back in leveling device and you are ready to get started. Go to detailed Instructions Step 1.

### INCLUDED IN KIT

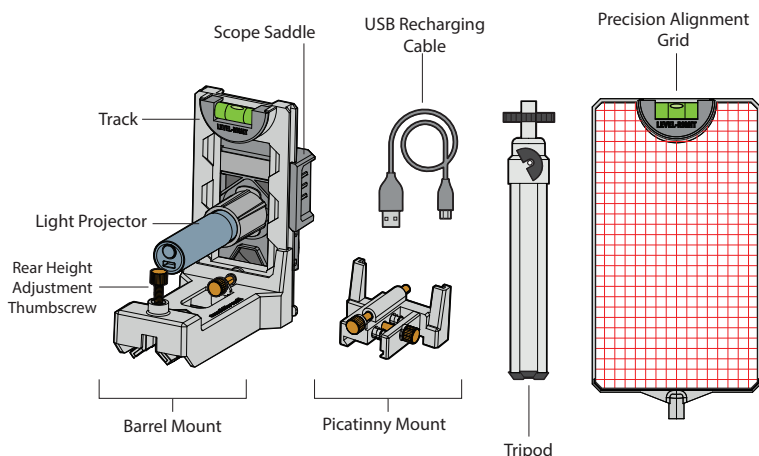

### ALSO REQUIRED

- Gun Vise
- Torque Driver



### HOW IT WORKS

The Level-Right Pro Precision Reticle Level utilizes dual anchor points (gun barrel or rail and the scope hood) to create a coupled vertical plane that can then be leveled horizontally.

The onboard Light Projector then projects the reticle onto the precision alignment grid. This can now be used to level the reticle of the scope and as a continual reference as the scope rings are tightened down to their correct torque specification.

### DETAILED INSTRUCTIONS

1. **Gun Safety is a priority. Before working on any firearm, make sure the gun is unloaded, the chamber is empty, and the gun is pointed in a safe direction.**

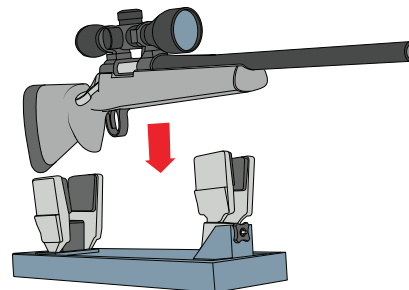

2. An area roughly twice the length of your gun may be necessary. Clamp your gun into a leveling vise.
3. As indicated in the "Before You Get Started" section, the scope rings should be loosened so the scope can freely rotate.
4. Choose the appropriate mount for the type of gun you are mounting to: picatinny or standard barrel. The mounts slide on from the bottom of the track and tighten down with a thumbscrew. The barrel should be unimpeded by iron sites and other barrel attachments.

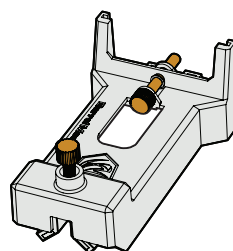

Barrel Mount

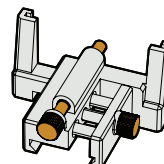

Picatinny Mount

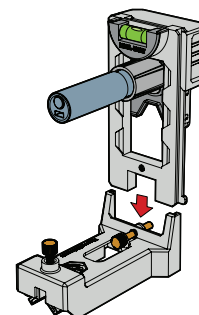

4A. **BARREL MOUNT:** Place the assembled Level-Right Pro directly on the barrel in front of the scope as shown, allowing magnets to engage barrel. Slide the Scope Saddle down to the scope so that both angled surfaces touch the outer diameter of the scope hood while ensuring that the barrel mount is still in place and secure.

Use the Rear Height Adjustment Thumbscrew to account for barrel taper. The Scope Saddle faceplate should be flush with the front face of the scope. The entire Level-Right Pro assembly should feel secured to the gun.

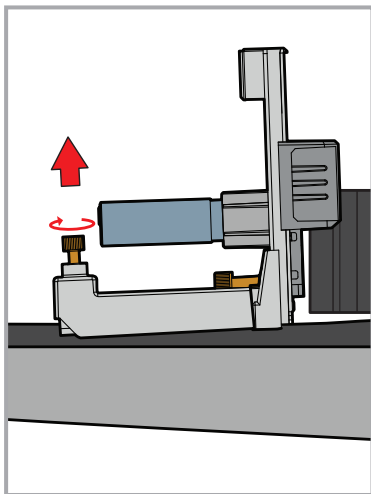
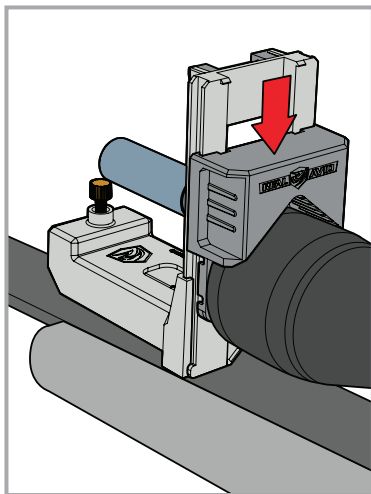

4B. **PICATINNY MOUNT:** Loosen the side clamp with the thumbscrew and place on the rail in front of the scope. Tighten down until snug. Do not overtighten or the mount may shift and skew results. Slide the Scope Saddle down to the scope so that both angled surfaces of the Scope Saddle touch the outer diameter of the scope.

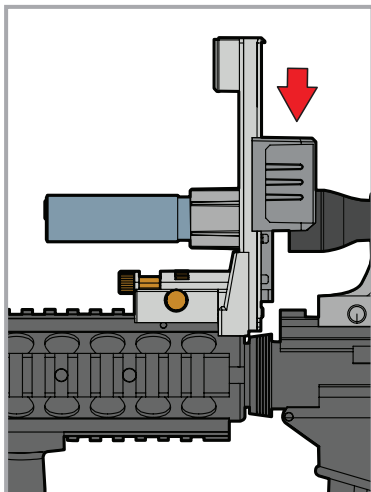
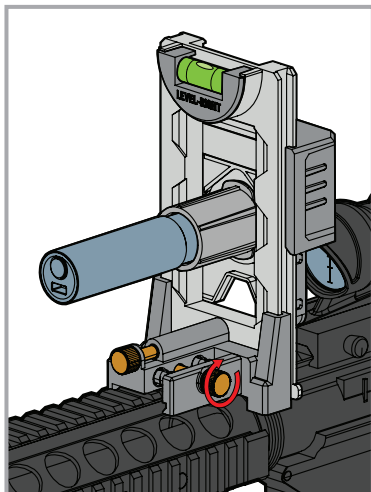

5. With either mounting base assembled, the Level-Right Pro device should feel secured to the gun. Reference the top level and make adjustments to your gun in the vise so the level reads horizontal.

6. Screw the base of the Precision Alignment Grid onto the tripod. Place tripod behind the stock with the grid surface facing the scope. The legs can be extended for extra height if needed. Adjust the Precision Alignment Grid with the side mounted set screw that tightens and loosens the ball joint to level the grid.

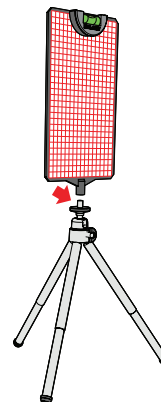
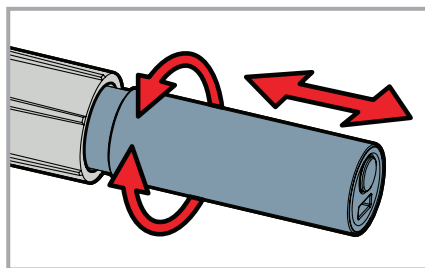

7. Darken the room or at least the area around the Precision Alignment Grid. Turn on the Projector by pressing the button on back. There are 3 levels of brightness that can be cycled through with each press of the button. The reticle shadow should be seen projected onto the Precision Alignment Grid.

8. Focus your scope, if equipped, with the magnification and reticle focus to get a crisp image of the reticle projection. With larger scopes, the entire reticle may not be visible. You can also use the Light Projector focus, which changes the angle of light. Simply pull, push, and rotate the black housing of the Projector to adjust.

9. Rotate the scope to match the reticle lines with the graph lines of the placard so they are parallel.

10. Continue to check the Level-Right Pro bubble level to ensure the gun remains level throughout the torquing process.

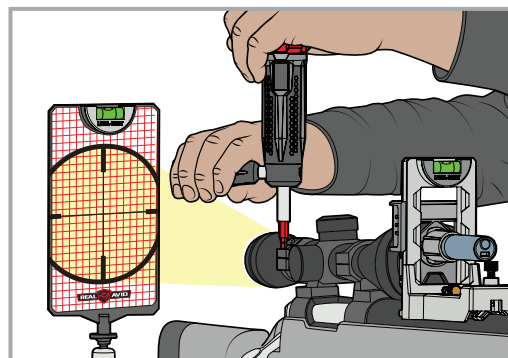
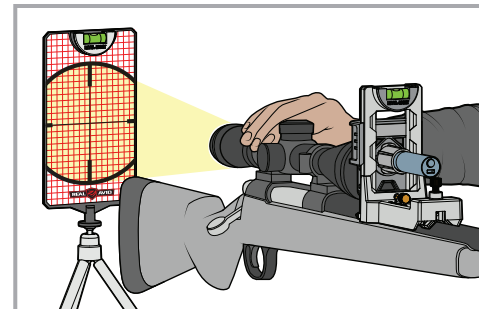

11. Use a torque driver to tighten down the rings to the correct manufacturer's torque specifications. Frequently observe the Level-Right Pro reticle projection on the Precision Alignment Grid to safeguard against the scope rotating during the tightening/torquing process.

**Congratulations!**  
**You now have a level reticle!**

MAINTENANCE

The Level-Right Pro is a precision tool and should be stored with care. Return to the box or in a location where there is no external pressure exerted on any of the components that would warp or bend the product over time. Keep in a cool, dry location. Should the Scope Saddle fail to slide sufficiently, apply a small amount of white lithium grease to the track rails to reduce friction.

LIGHT PROJECTOR RECHARGING INSTRUCTIONS

- 1. The Light Projector battery will eventually need to be charged when it no longer produces a bright projection.
- 2. Remove the Light Projector from the device by twisting it counterclockwise out of the scope hood.
- 3. Plug the included micro-USB cable into the Light Projector end, and the USB end into a computer, laptop or USB wall outlet adapter (not included).
- 4. The Light Projector button will display red when it is charging and change to green when fully charged.
- 5. Reinstall the Light Projector into the Level-Right Hood by fitting and twisting it clockwise back into the Scope Hood housing.

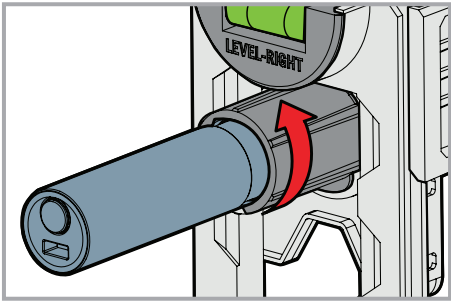

NOTES:

WARRANTY

**WARRANTY: LIMITED – 3 YEAR WARRANTY:** The Level-Right Pro is guaranteed free of defects in materials and workmanship for three years from date of original purchase. Real Avid will replace or repair any product that proves defective upon our inspection. Use of the Level-Right Pro for anything other than its intended purpose is considered misuse and voids this warranty. For warranty service, send the product, proof of purchase with shipping paid, along with an explanation of the defect, as well as your name, address and phone number to our address (on opposite page). This warranty excludes damage resulting from deliberate or accidental misuse. Warranty does not cover rust, stains or corrosion, or normal wear and tear. Repair or replacement is the exclusive remedy under this warranty. Real Avid, its partners and affiliates are not liable for incidental or consequential damage resulting from use. Some states do not allow exclusion or limitation of incidental or consequential damages; therefore, the above exclusions may not apply to you. This warranty gives you specific legal rights, and you may have other rights, which vary from state to state.

SMART-TORQ®  
MASTER GRADE® 1 INCH-LB TORQUE DRIVER

Once you've leveled the reticle, it's time to lock it down. Base and scope ring manufacturers do exhaustive testing and validation to identify specific torque settings and specifications for their products to not only perform optimally but prevent damage to scope tubes. An inch-lb torque driver is critical to meeting those specifications.

The Smart-Torq was designed to be the most precise and technically advanced in-lb torque driver for guns. Specifically developed for optics mounting and gun builds. Discrete in-lb increment settings provide spot-on torque adjustments. The comfortable grip with Force Assist™ makes tool manipulation a breeze. Functionally intuitive torque setting with visual, tactile and audible feedback provides confident assurance.

PRECISION TORQUE  
DRIVER FOR FIREARMS.



**TO FRIENDS AND CUSTOMERS:** As the owners of Real Avid, authenticity isn't just a strategy here. It's a guiding philosophy. It arises out of our faith and personal relationships with Jesus Christ. We know that our creativity and success ultimately comes from Him. He cares about each of us and about our customers. We're not perfect, but we are committed to following Him in our personal and business lives.

We look forward to growing our relationship with you and continuing to earn our place.



Maple Grove, MN

800.286.0567

**RealAvid.com**